

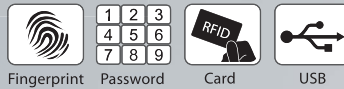

Be in control with Keylock 7700



Keylock 7700 is a mechanical door lock unit, designed to be installed onto the door of a restricted area, replacing the traditional key and lock doorknob. With Keylock 7700, you will need to scan your fingerprint, card or insert a 6-digit password to unlock the door, instead of using a conventional key, which is easily forgeable. The sleek zinc alloy finish of Keylock 7700 comes with a sturdy bar-latch which can be easily switched around to suit right-open or left-open doors. It is ideal for use on high security storerooms or offices of high-ranking executives, as it comes with the option of a secure double-tongue door latch, which is durable and difficult to bypass by those with ill intentions. That's not all, as Keylock 7700 is FingerTec's first mechanical door lock to support time zone settings, besides having a capacity of 500 fingerprints, card and password each.



Multi-Verification Methods

Keylock 7700 supports a few verification methods, such as fingerprint, 6-digit password, and even card verification. Choices, choices.



Stylish Outlook

The smooth zinc alloy finish combined with a classic black touch screen gives the device a polished look suitable for any professional workplace or SME.

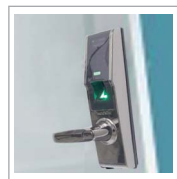

Minimal Space Usage

Keylock 7700 is installed on a door itself, saving wall space and efforts of wall-hacking for installation.

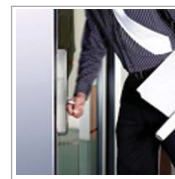

Visitor-Friendly

Expecting some unregistered guests? No problem. Keylock 7700 only locks when you raise the inner bar latch a little upwards. So you can be in control of when your door is locked and unlocked.



Optimal Battery Life

Keylock 7700 functions on battery power, and the device itself is programmed to optimize the life of the inserted batteries by going into power save mode when left idle for too long.

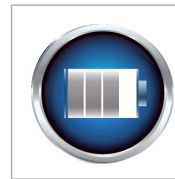

Large Capacity

Keylock 7700 contains a large memory capacity of 32MB, more than enough to hold the 500 fingerprint and 500 passwords enrolled, as well as transaction logs and time zone settings.



USB Management

With the USB management style of Keylock 7700, data transfer couldn't get easier. Downloading transaction logs is now a matter of a few steps.



Latest Algorithm

Nothing but the best is used for Keylock 7700, which is why it supports the latest VX10.0 algorithm for a faster, and more accurate fingerprint scanning.

WEB LINK



• <http://info.fingertec.com/keylock7700-1>



• <http://info.fingertec.com/keylock7700-2>



• <http://info.fingertec.com/keylock7700-3>



• <http://info.fingertec.com/keylock7700-4>



• <http://info.fingertec.com/keylock7700-5>



• <http://info.fingertec.com/keylock7700-6>

LAYOUT PLAN

Installation Diagram

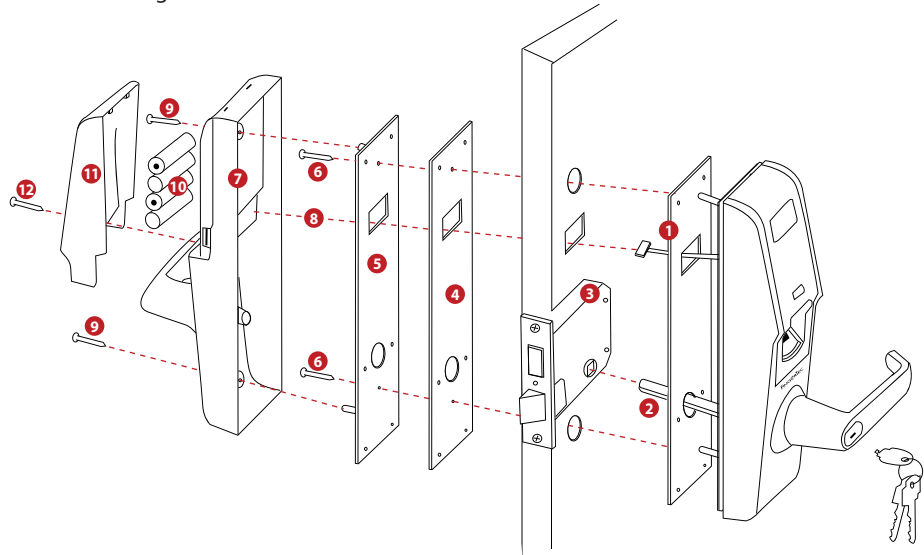

SPECIFICATIONS

MODEL	Keylock 7700	
SURFACE FINISHING	Zinc alloy	
TYPES OF SCANNER	Optical fingerprint scanner	
DISPLAY	OLED black and white display	
MICROPROCESSOR	400 MHz	
MEMORY	32 MB flash memory	
ALGORITHM	Biobridge VX 10.0	
RESOLUTION OF SCANNER (dpi)	560	
PRODUCT DIMENSION (L X W X H), mm	Front panel: 150 x 93 x 268 (with handle) 70 x 50 x 268 (without handle)	Back panel: 150 x 90 x 268 (with handle) 70 x 90 x 268 (without handle)
• Thickness of door, mm	35 - 70	
• Door latch type	Single tongue (Keylock 7700S) Double tongue (Keylock 7700D)	
• Inner lock switch	Yes	
STORAGE		
• Fingerprint templates	500	
• Passwords	100	
• Cards	100	
• Transactions	30000	
ENROLLMENT & VERIFICATION		
• Methods	Fingerprint (1:1, 1:N), card & password	
• Recommended fingerprint per user ID	2	
• Fingerprint placement	Any angles	
• Verification time (sec)	< 1	
• FAR (%)	< 0.0001	
• FRR (%)	< 1	
• Length of password (digits)	6	
CARD TECHNOLOGY		
• RFID: 64-bit, 125kHz	Yes	
• MIFARE: MFIS50/S70, 13.56MHz	Made to order	
COMMUNICATIONS		
• Method	USB disk	
OPERATING ENVIRONMENT		
• Temperature (°C)	0 ~ 45	
• Humidity (%)	20 ~ 80	
• Power input	4 x 1.5 V AA battery for 4000 operations	
• Power consumption – static (µA)	< 35	
• Power consumption – activity (mA)	< 150	
• Power consumption – driving (mA)	< 200	
• Antistatic voltage (V)	> 1500	
• Low battery warning voltage (V)	< 4.5	
BACKUP UNLOCK MECHANISM	Battery & mechanical key	
VOICE / DISPLAY LANGUAGE (TERMINAL)	English (Standard), other languages are available upon request.	
SOFTWARE LANGUAGE	English, Arabic, Chinese Traditional / Simplified, Spanish, Thai, Russian, Malay. Other languages are available upon request.	

NOTE: Specifications are subject to change. Check <http://product.fingertec.com> for latest product information.

Authorized Reseller:



Packaging

Dimension (mm) : 410 (L) x 140 (W) x 225 (H)
Weight : 4.75 kg



FINGERTEC
www.fingertec.com
© 2000-2014 FingerTec Worldwide Limited. All rights reserved.