

Advanced and Simplest Wi-Fi Hotspot Solution

Most Advanced & Simplest Wi-Fi Hotspot Solution for Coffee Shops & Restaurants

Social Media Login | Customized Login Pages | User Data Collection



"4ipnet HSG326 + WTG is the most Economical, Feature-Rich and the Simplest Wireless Hotspot Solution which can be Configured in no time."

Social Media Login & Demographics

4ipnet's social media login integration offers businesses providing free Wi-Fi with additional tools for more effective customer insights and marketing. Guests can easily login to Wi-Fi using their Facebook, Google+, LINE, VK, or OpenID accounts, allowing business owners to collect basic profile information such as gender, location, and birthday.



User Data Collection

Business owners can collect valuable Guest data such as Name, Email ID & Mobile Nos and save it in the Internal Memory of the Hotspot Gateway. With the collected Information Business owners can better understand their target audience & optimize product offerings & Promotional Programs, resulting

in more effective campaigns & increased revenue.

Customized Login Pages

Allows you to quickly enable multiple unique Wi-Fi login pages per deployment depending on various access point locations. Each login page is fully customizable to show unique branding or location-based advertisements, and can also be designed with customer-defined data fields for collecting relevant data for analytics and marketing.





InBuilt Wi-Fi

Inbuilt Wi-Fi with Latest 802.11ac Wi-Fi Technology & 2x2 MIMO supporting a total Data Rate of 1.2 Gbps. 21dbm Output Power for Longer Coverage. Can also give connectivity to one access point in WDS mode.

Multi-factor Email Authentication

With 4ipnet's guest Wi-Fi email login mechanism, network administrators are able to validate the authenticity of the entered email addresses by granting users with limited access until the activation link is triggered. Furthermore, given the ease of free email account registration, device MAC addresses are also logged to maintain the integrity of the set access limitations, such as duration per access or number of reactivations per day.

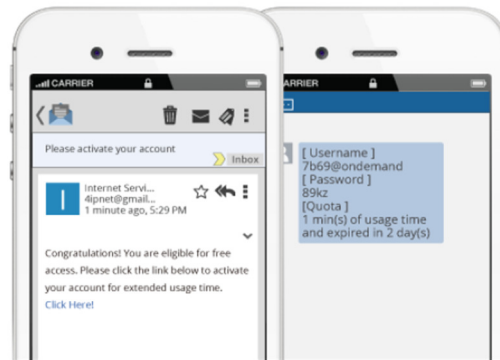

Billing Plans

By limiting free Wi-Fi access by duration or time, venue owners can better maintain open seats for new purchasing customers. Multiple billing plans can also be enabled to create tiered Wi-Fi service with different usage

quotas, price, and network access privileges. Finally, a tablet-based billing plan selection interface provides a simple way to create accounts for guests.

Detailed User Logs & Reports

With increasing security regulations in both public and enterprise Wi-Fi deployments, WLAN solutions need to be able to effectively track all network activity. 4ipnet offers a complete set of logs & reports from its

monitoring interface, including user browsing histories, NAT conversion logs, and all authentication related events.



Summary of Features:

- All-in-one: built-in Wi-Fi & user access control
- Latest Wi-Fi Technology 802.11ac 2x2 MIMO with fastest speed of 1.2 Gbps
- Social Media Login & User Data collection
- Login / Landing Page Customization
- User level Bandwidth Limitation Per User/Group/Service Zones
- MAC address Filtering
- Billing Plans - Hourly, Daily, Weekly, Monthly & yearly billing plans for all Guest & Users
- Wi-Fi service with usage quotas by bandwidth, volume, and duration
- Detailed user browsing histories and network statistics
- Gateway for WAN Connectivity. Built-in gateway functionality including DHCP, NAT, and routing profiles
- Quick integration with 4ipnet WTG ticket printer for guest on-demand account generation